

Q-10

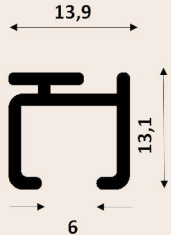

RAL 9016

Bianco

RAL 9005

Nero

Alluminio

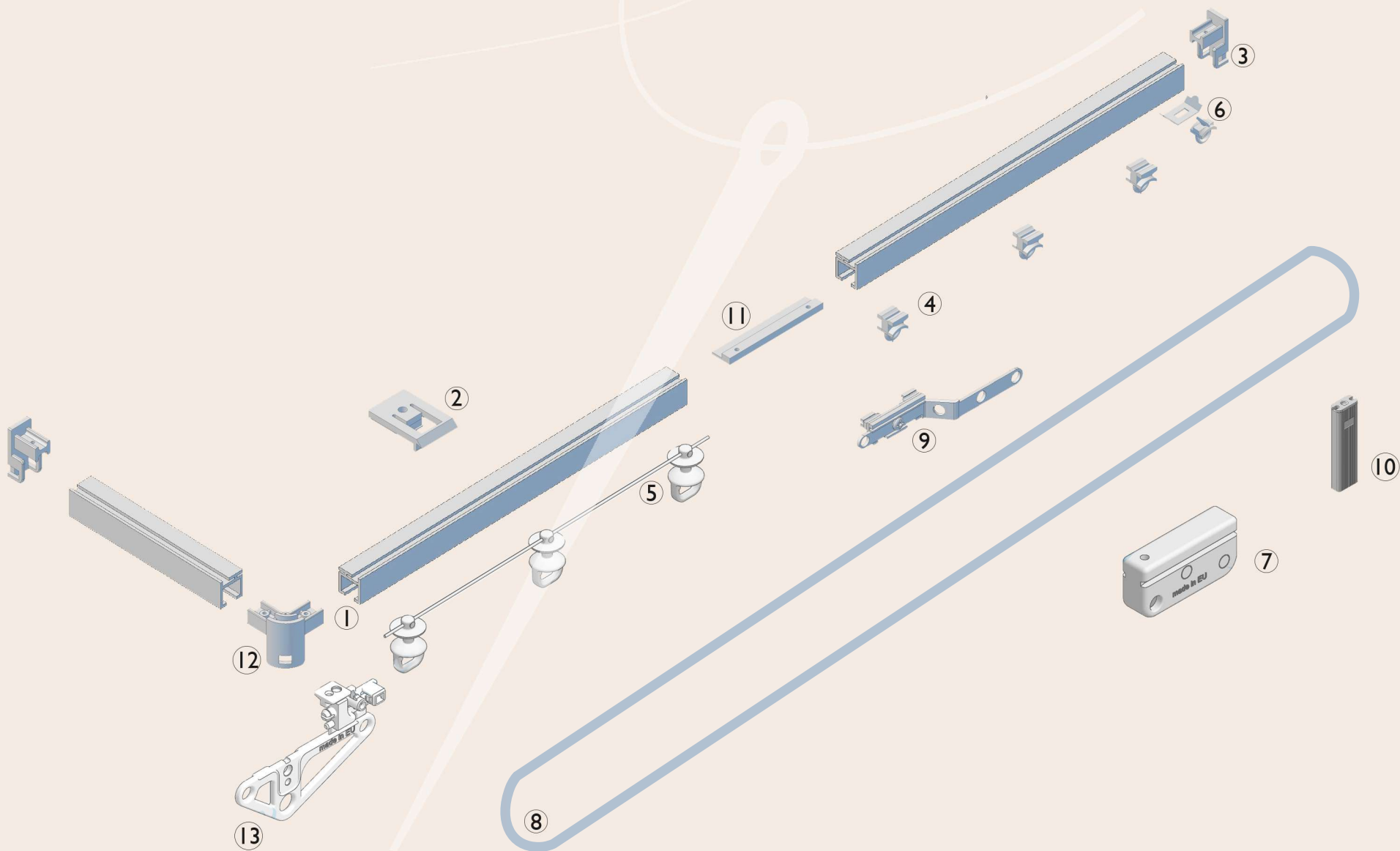

Accessori binari in dotazione

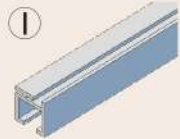

① Profilo in alluminio disponibile nei colori:
-Bianco,
-Nero,
Acciaio satinato



② Supporto in Plastica



③ Tappo in Plastica

Scorrevole in plastica per tenda tradizionale



④

Scorrevole con cordino per tenda a onda

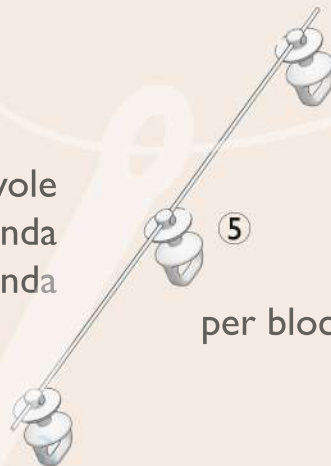

⑤ Fermo viene posizionato prima dell'ultimo scorrevole dal lato della raccolta, per bloccare la tenda da un lato.



⑥



Componenti movimento a corda



⑦ Carrucola per movimento a corda

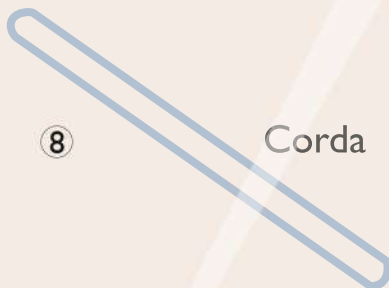

⑧

Corda

⑨



Carrello

⑩

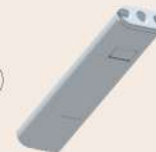

Fiocco

Giunzione binario



⑪

Angolo Binario



⑫

Scorrevole inizio Onda

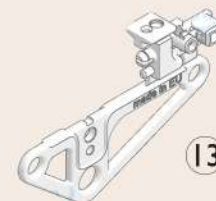

⑬

Optional